

## How to safely remove PPE after tool reprocessing

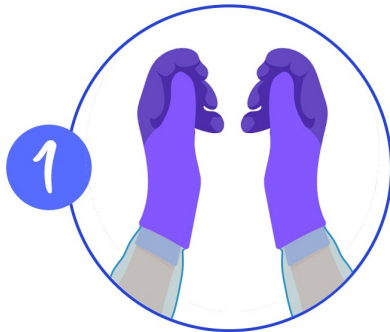

1  
You should consider the exterior of both pairs of gloves and sleeve contaminated

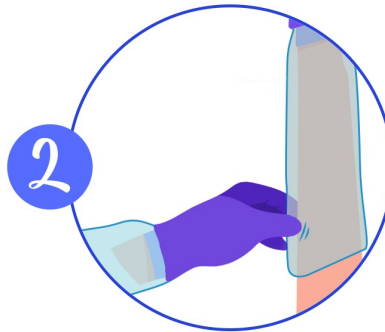

2  
Begin by grabbing the OUTSIDE of your dominant sleeve and pull outwards

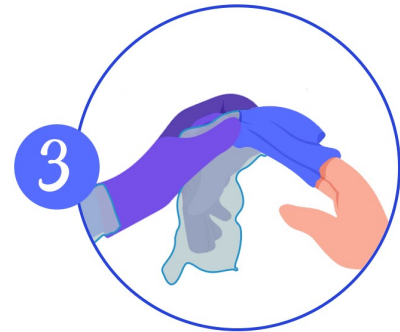

3  
Ensure you collect both pairs of gloves in the process and not to touch skin

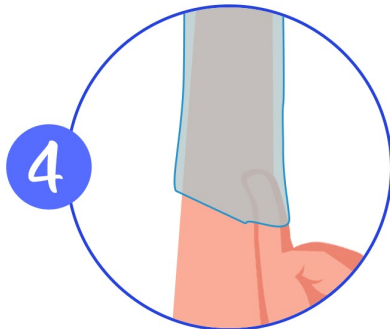

4  
Now insert your dominant hand's index finger INSIDE the other sleeve

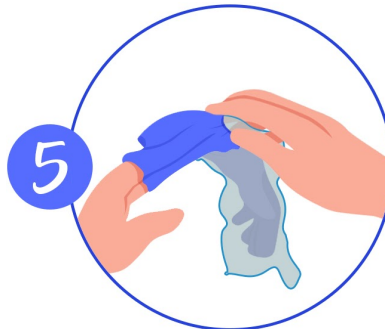

5  
Remove sleeve and both pairs of gloves, ensuring to only touch the INSIDE of gloves and sleeve

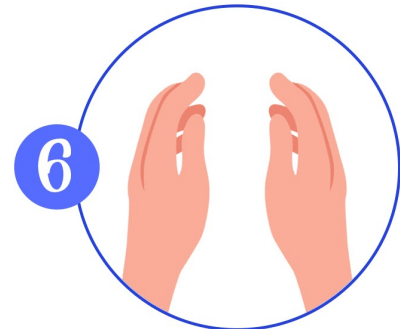

6  
Now you should wash your hands before removing mask or other facial PPE